



## 1/2" Manual Reset Snap Disc Thermostats

## 432 SERIES

Quality-engineered 1/2" snap disc thermal sensors specifically designed for a variety of applications, such as, HVAC Equipment and Food Service Equipment, to act as a high limit temperature device.

The 432 Series is our 1/2" manual reset snap disc thermostat. This series is ideally suited for applications where you want to call special attention to a specific temperature malfunction.

The 432 thermostats use a bi-metal disc for snap action, providing positive and instantaneous opening of the electric circuit. The 432 series feature trip-free (M2) operation. Physical depression of the reset button holds the contact open and renders the device inoperative until the reset button is released.

The 432 series can be used as a safety limit that will break on temperature rise, or as a fan (cooling) limit that will break on temperature fall. Once tripped, the thermostat can be reset once the temperature has changed a minimum of 25°F. The reset differential will increase as the specified break temperature increases. The minimum reset temperature is 75°F (24°C).

To insure that a safe combination of thermostat and application is achieved, the purchaser must determine product suitability for their individual requirements.

- Accurate Air And Surface Temperature Regulation
- Single-pole, single-throw (SPST)
- Manufactured to individual temperature specifications within 100°F to 350°F (37°C to 176°C). Consult factory for applications below 100°F (37°C).
- Differential temperature range of 25°F minimum.
- Temperature calibrations are preset, and all units are subject to 100% mechanical and thermal inspection.
- Great for unique applications which require a faster response time or a lower contact resistance.
- Opens on Temperature Rise or Fall
- Enclosed bi-metal discs
- Available in a variety of terminal and mounting configurations, and other custom options to meet needs of original equipment manufacturers.
- Recognized by UL/cUL

## Standard Temperature Options

### 1/2" Manual Reset Snap Disc Thermostats (432 Series)

Temperature Set Point Ranges	Tolerance
If unit falls in overlapping range use higher range	Allowance <sup>±</sup> at temperature set points
	<b>Open</b>
100° to 200°F (38 to 93°C)	±8°F (±4°C)
201°F to 250°F (94 to 121°C)	±10°F (±6°C)
251 to 350°F (122 to 177°C)	±12°F (±7°C)

Flip for complete fact sheet. >>>

### No Mount

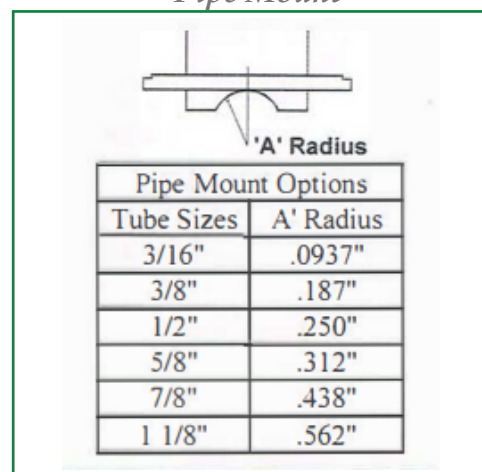

## 432 Series Terminal Options All dimensions inches/millimeters.

### Solder Terminals

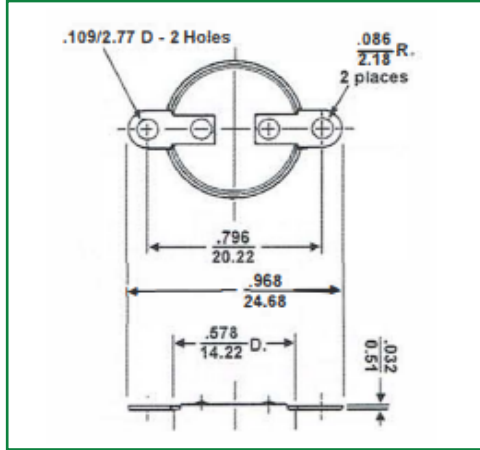

### 1/4" Quick Connect Terminals

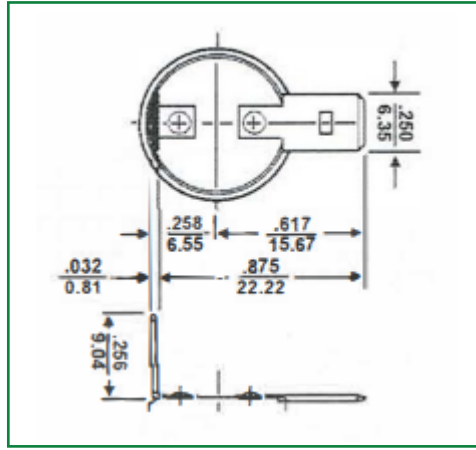

### Flat Eyelet

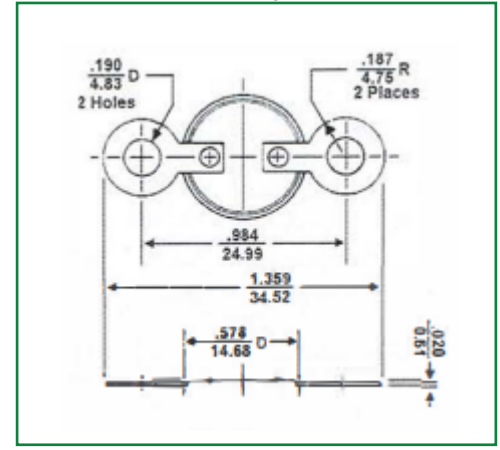

### Wire Crimp

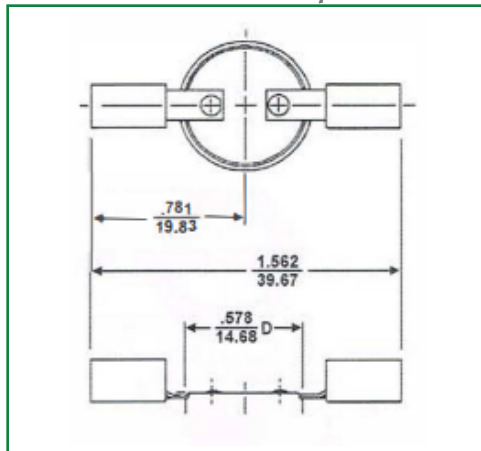

### 3/16" Quick Connect Terminals

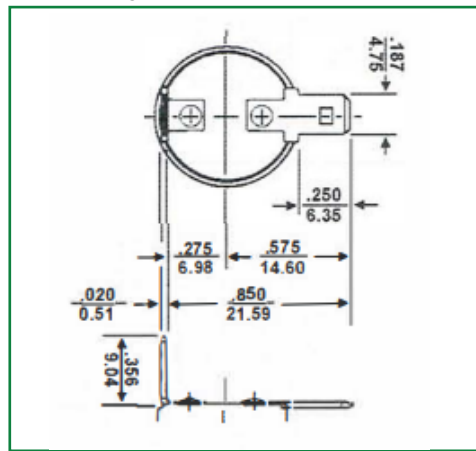

### Other Standard Terminal Bends

#### 45° Bend Shown



#### 90° Bend Shown



## Electrical Ratings

All 6,000 cycle ratings.

LOAD	120 VAC	240 VAC	277 VAC
Resistive	15 Amps	10 Amps	8.7 Amps
Inductive	5.8 FLA	2.9 FLA	N/A
	34.8 LRA	17.4 LRA	
Pilot Duty	125 VA		
Millivolt	125 VA Pilot Duty, 120-277 VAC .5A Resistive 24 VDC		

## Custom Solutions Available

Our standard 432 units terminal orientation is 90° as shown. We offer other common orientations available such as 45° and 0°. Please consult factory for more information.

Senasys offers a variety of custom brackets such as pipe (tube) and stud mounts. We also offer a variety of custom terminal options such as blade and fork, and other orientations and bends that aren't shown. If you have a requirement that is not shown here, please consult factory.

Determine your part number from our standard list of options below. Consult factory for other custom options such as terminal types, special brackets, etc.

1/2" Manual Reset Snap Disc Thermostats (432 Series) Nomenclature & Standard Product Options									
Series	-	Body Type		Mounting Bracket		Terminals		-	Temp Code
<b>432</b>				<b>0</b>	Direct	<b>0</b>	Flat Eyelet		<b>###</b>
1/2" Manual Reset Snap Disc Thermostat, Single-pole, Single-throw (SPST)		<b>301A</b>	Enclosed	<b>1</b>	Surface Mount	<b>1</b>	Solder 0° Bend	Consult factory for temperature code.	<b>432-301AA03-510</b>
				<b>2</b>	Large Surface		Solder 90° Bend		
				<b>3</b>	Loose Hold				
				<b>4</b>	Airstream				
				<b>5</b>	Large Airstream				
		<b>301B</b>	Castle	<b>6</b>	#6-32 Stud Mount	<b>3</b>	1/4" QC at 0° Bend		
				<b>7</b>	M5x0.8 Stud Mount				
				<b>8</b>	1/8-27 NPT Stud Mount				
				<b>A(#)</b>	Aluminum Pipe Mount Choose pipe mount size below (#)		1/4" QC at 45° Bend		
				<b>0</b>	Outer Diameter 0.187"				
		<b>301C</b>	Enclosed, Gold Contacts	<b>1</b>	Outer Diameter 0.375"	<b>5</b>	1/4" QC at 90° Bend		
				<b>2</b>	Outer Diameter 0.500"				
				<b>3</b>	Outer Diameter 0.625"				
				<b>4</b>	Outer Diameter 0.875"				
				<b>5</b>	Outer Diameter 1.125"				
		<b>301D</b>	Castle, Gold Contacts	<b>7</b>	Outer Diameter 0.250"	<b>7</b>	3/16" QC at 0° Bend		
				<b>8</b>	Outer Diameter 0.437"				